



MERYWEN







MWD
architects
+ makers

The Merywen

Our standard Merywen design comprises a highly insulated core clad in local Welsh larch. Inspired by traditional Japanese architecture, it is designed to be versatile, economical and contemporary and provide space ancillary to the main living quarters. It is also ideal as a camping pod for paying guests on glamping and camping sites or holiday parks.

As part of our standard service, our architects will take care of any planning applications, so you do not have to worry when purchasing a Merywen. If you require changes to the standard internal configuration we will work with you in finding a bespoke solution that meets your needs.



DESIGN INSPIRATION

"Merywen" (Welsh) - Juniper

The inspiration for our Merywen has been taken from traditional Japanese architecture and Zen simplicity. The structure collects everything that is essential in one place, eliminating the superfluous and creating a space that is neat and harmonious.

The juniper tree is one of the most popular types of bonsai to grow in Japan. Many Rinzai Zen temples in Japan have a juniper tree planted at the gateway.



Traditionally, Japanese buildings reflect a strong emphasis on their relationship with nature and their appreciation of wood in its natural form. The Merywen, with its clean and simple lines, is clad in untreated Welsh Larch which will weather and age naturally over its life time, whilst the natural resins inside the wood protect it from rot and decay.

A Kusari-doi or rain chain guides rainwater runoff from the roof. Considered both aesthetically pleasing and functional, rain chains were used in Japan to enhance the sound of the water running out of the gutter.

With the incorporation of Sashiko stitches in the upholstery and soft-furnishings, Merywen follows the aesthetics of Wabi Sabi, a way of appreciating beauty as imperfect, impermanent and incomplete.

2.4 by 2.4m core

4.7m² Internal floor area

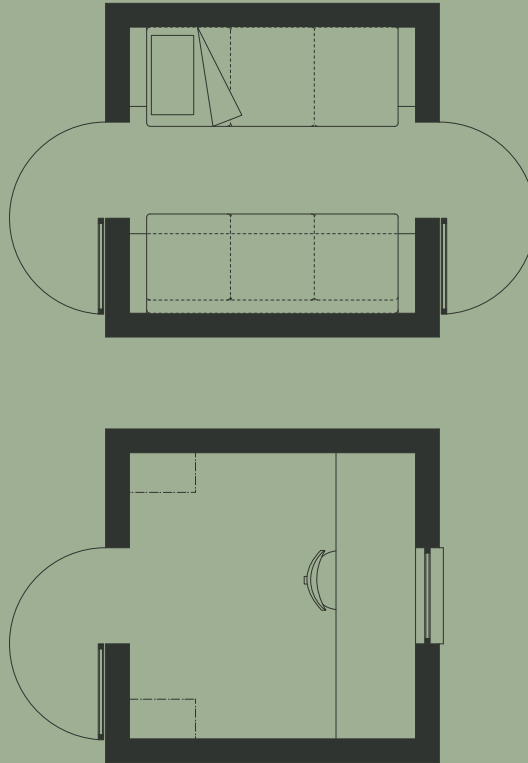

	STANDARD	OPTIONAL EXTRAS
CORE	Insulated core VELFAC windows and doors Electric underfloor heating	2 x Sofa beds Shelving units Fitted desk Side Window(s)

NOTES: Connection will be required to single phase electricity supply. Alternatively for off-grid version photovoltaic panels will need to be located remotely to the pod. A battery bank can be integrated into pod. Foundations to be composed of a grid of four pads - loadings can be supplied on request. Access board-walks and deck can be supplied to suit specifics of site.

2.4 by 3.6m core

7.3m² Internal floor area

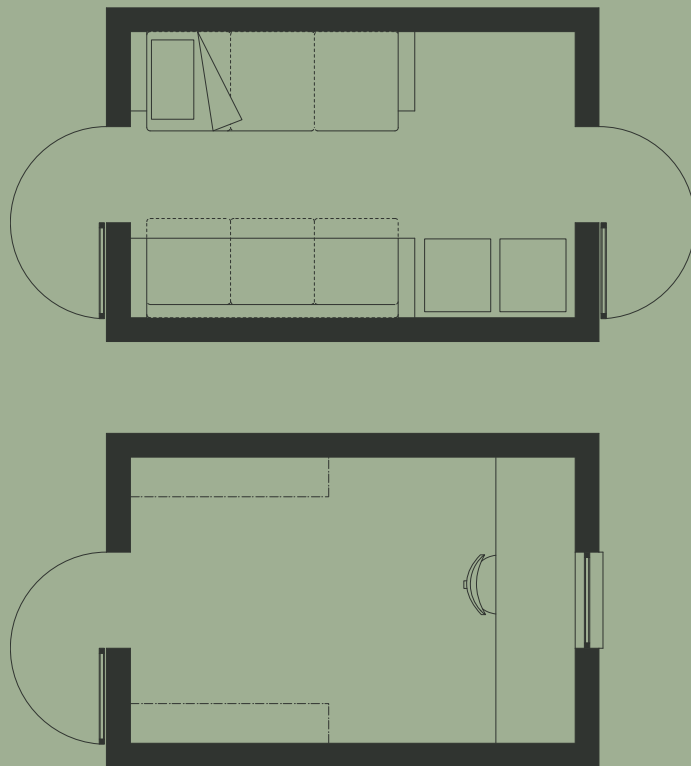

	STANDARD	OPTIONAL EXTRAS
CORE	Insulated core VELFAC windows and doors Electric underfloor heating	2 x Sofa beds Shelving units Fitted desk Side Window(s)

NOTES: Connection will be required to single phase electricity supply. Alternatively for off-grid version photovoltaic panels will need to be located remotely to the pod. A battery bank can be integrated into pod. Foundations to be composed of a grid of four pads - loadings can be supplied on request. Access board-walks and deck can be supplied to suit specifics of site.

2.4 by 4.8m core

9.9m² Internal floor area

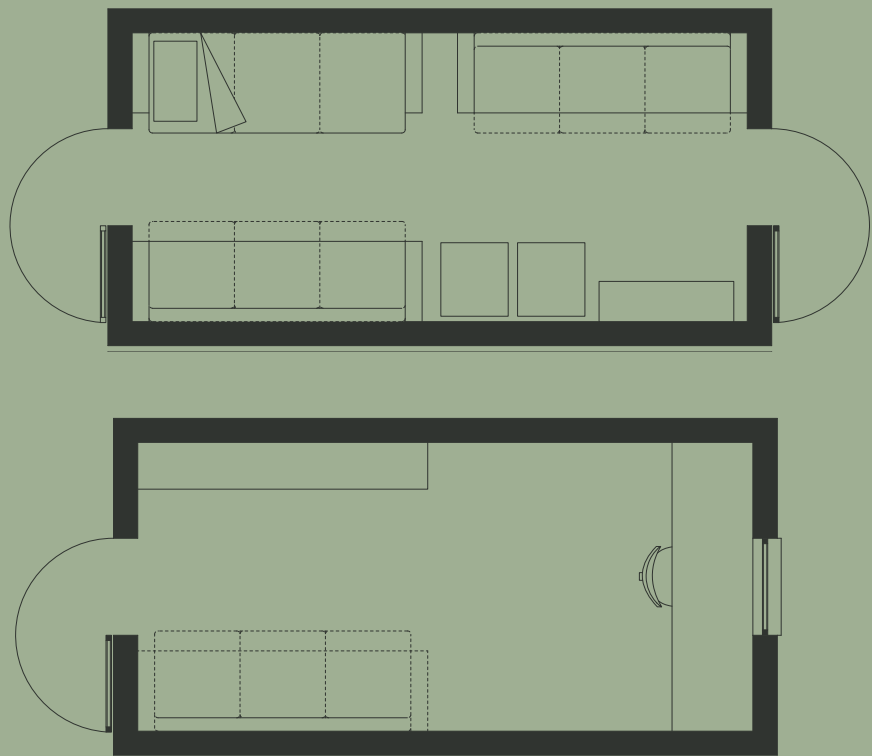

	STANDARD	OPTIONAL EXTRAS
CORE	Insulated core VELFAC windows and doors Electric underfloor heating	2 x Sofa beds Shelving units Fitted desk Side Window(s)

NOTES: Connection will be required to single phase electricity supply. Alternatively for off-grid version photovoltaic panels will need to be located remotely to the pod. A battery bank can be integrated into pod. Foundations to be composed of a grid of four pads - loadings can be supplied on request. Access board-walks and deck can be supplied to suit specifics of site.

2.4 by 4.8m core

9.9m² Internal floor area plus 2.7m² external for the shower room

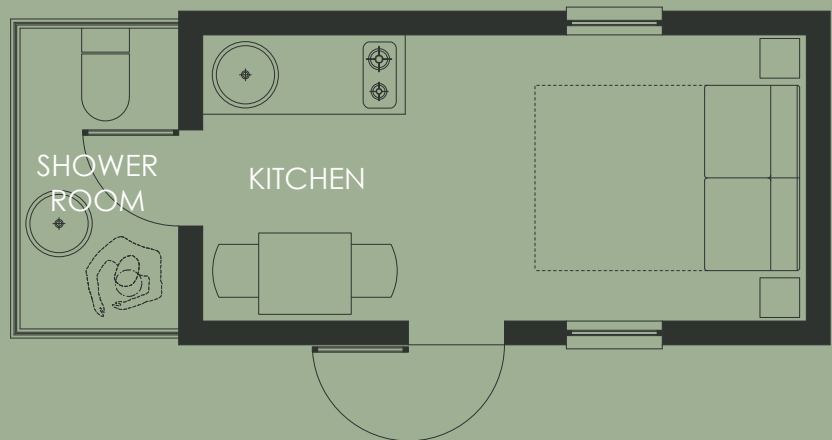

	STANDARD	OPTIONAL EXTRAS
CORE	insulated core VELFAC windows and doors Electric underfloor heating	2 x Sofa beds Fitted desk
KITCHEN	Fitted kitchen including sink & hob High level shelving	Fridge freezer Oven
SHOWER ROOM	Fitted shower room with shower Free standing basin and toilet	Radiant heating Compost toilet

NOTES: Connection will be required to sewer or septic tank, cold water supply and single phase electricity supply. Alternatively for off-grid version with compost toilet, photovoltaic panels will need to be located remotely to the pod. A battery bank can be integrated into pod. Foundations to be composed of a grid of four pads - loadings can be supplied on request. Access board-walks and deck can be supplied to suit specifics of site.

2.4 by 6m core

12.5m² Internal floor area

NOTES: Bespoke options can be developed to suit individual needs.

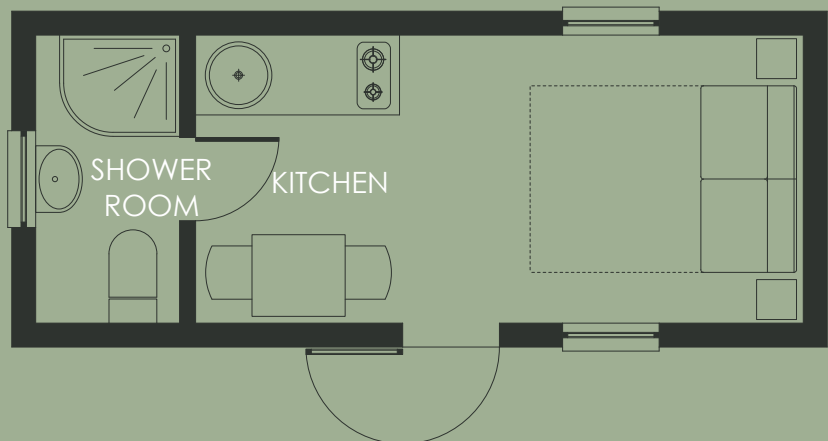

	STANDARD	OPTIONAL EXTRAS
CORE	insulated core VELFAC windows and doors Electric underfloor heating	Sofa bed
KITCHEN	Fitted kitchen including sink & hob High level shelving	Fridge freezer Oven
SHOWER ROOM	Fitted shower room with shower Free standing basin and toilet	Compost toilet

NOTES: Connection will be required to sewer or septic tank, cold water supply and single phase electricity supply. Alternatively for off-grid version with compost toilet, photovoltaic panels will need to be located remotely to the pod. A battery bank can be integrated into pod. Foundations to be composed of a grid of four pads - loadings can be supplied on request. Access board-walks and deck can be supplied to suit specifics of site.

ENVIRONMENT & MATERIALS

Structurally Insulated Panels (SIPS):

The SIPS panels are used to create a core which is highly insulated, providing a comfortable thermal environment in all weather. Manufactured locally to our studio, we ensure minimal transport emissions and work closely with the manufacturer to provide quality assurance.

Birch ply:

We source all of our plywood from FSC certified manufacturers from Europe. Birch is native to Europe and is a renewable source of timber. Birch ply offers excellent strength and durability with minimal defects.

Welsh Larch:

All of our larch cladding boards are from the local area and cut to size at a local saw mill.



Windows & doors:

All the windows and doors are supplied by Velfac, a Danish company. They are aluminium clad wood, which is FSC certified. The windows and doors have a lifespan of at least 40 years, with Velfac providing a 12-year product warranty.

Steel:

Our steel is fabricated locally, this allows us to minimise emissions due to transport whilst working closely with the steel fabricator.

Heating:

The Merywen requires minimal heating due to its highly insulated core but Electric underfloor heating is included as standard in the core of all models.

Marmoleum Floor:

Marmoleum has a very low carbon footprint. It is composed of 97% natural materials and uses 43% recycled materials.

EPDM Roof Finish:

EPDM has a low GWP (global warming potential) and can be reused and recycled into many different products. It has a life span of between 25-50 years and doesn't pollute rainwater so is an ideal material for rainwater harvesting. This finish can be used in conjunction with a sedum roof.

Rainchain:

We have collaborated with renowned local ceramicist Lindy Martin to develop a unique design for the rain chain, inspired by traditional Japanese architecture.



QUALITY & CRAFTSMANSHIP

Trust, reputation and reliability are the hallmarks of our chosen local craftspeople. We made the decision to manufacture our pods in a dedicated facility in the heart of Wales, a stone's throw away from our design studio. We are able to undertake regular site visits to ensure our delivery team on the ground have the support they need to exceed expectations.

Our use of quality components including birch plywood for the internal fittings, VELFAC windows and doors, Welsh larch cladding and the highly insulated core work together to deliver a durable, high-performance, and economical space.

The Merywen has been ergonomically designed with the process of delivery and assembly in mind. Our team will work with you to help ensure that site specific obstacles that could impact construction, delivery and assembly are carefully logged and assessed. Our processes have been streamlined to deliver ease, peace of mind and long-lasting value.

We have developed robust quality monitoring systems to ensure that the construction of our pods meets the high standards we have imposed on ourselves. These standards have been influenced by our professional training and experience, together with feedback from end users. We monitor our processes at regular intervals to ensure we learn from each stage of each and every build. Upon delivery, our team will undertake final checks to ensure the Merywen is assembled to agreed parameters.





19 new road
llandeilo
carmarthenshire
sa19 6dd

01558 822009

info@mwd.wales

mwd.wales