

HELYGEN®





HELIGEN®

Nature is the leading inspiration for the Helygen®.

The Helygen® has been designed to enhance our interaction with nature and harness the power and beauty of the natural world.

Light floods the Helygen® and interacts with the external cladding, creating vivid and interesting shadowing patterns

The Helygen® is a progressive design that differs from the standardised pod design in a number of fundamental ways.

MWD
architects
+ makers

DESIGN INSPIRATION

Nature is the leading inspiration for the Helygen®.

The aim is to create a space that although striking, blends with its surroundings, smoothing the transition between the natural world and the constructed environment.

Natural materials, such as larch cladding, are utilised alongside modern materials to produce a design that balances concerns for the immediate and wider environment with the need for functional usage and aesthetic elegance.

The humble willow tree was the inspiration for the external cladding. As the tree ages, the bark of the willow splits, producing an abstract lattice. How light from the sun interacts with the swaying branches of the tree has also influenced the design. The sun casts beautiful shadows and alternative perspectives are created through which the beauty of nature can be appreciated. To pay homage to the willow, and to the nature that inspired us, we chose to name our pod "Helygen®" – the Welsh translation of willow.

We are conscious of the impact our designs have on the natural world and Helygen® is a responsive design that sits comfortably within different settings, such as green pastures and woodlands and more built-up environments such as towns and villages.

Designed with functionality and versatility in mind, Helygen® offers individuals, couples and groups a space to settle in comfort and style.

2.4 x 2.4m core

Diameter = 5.2m

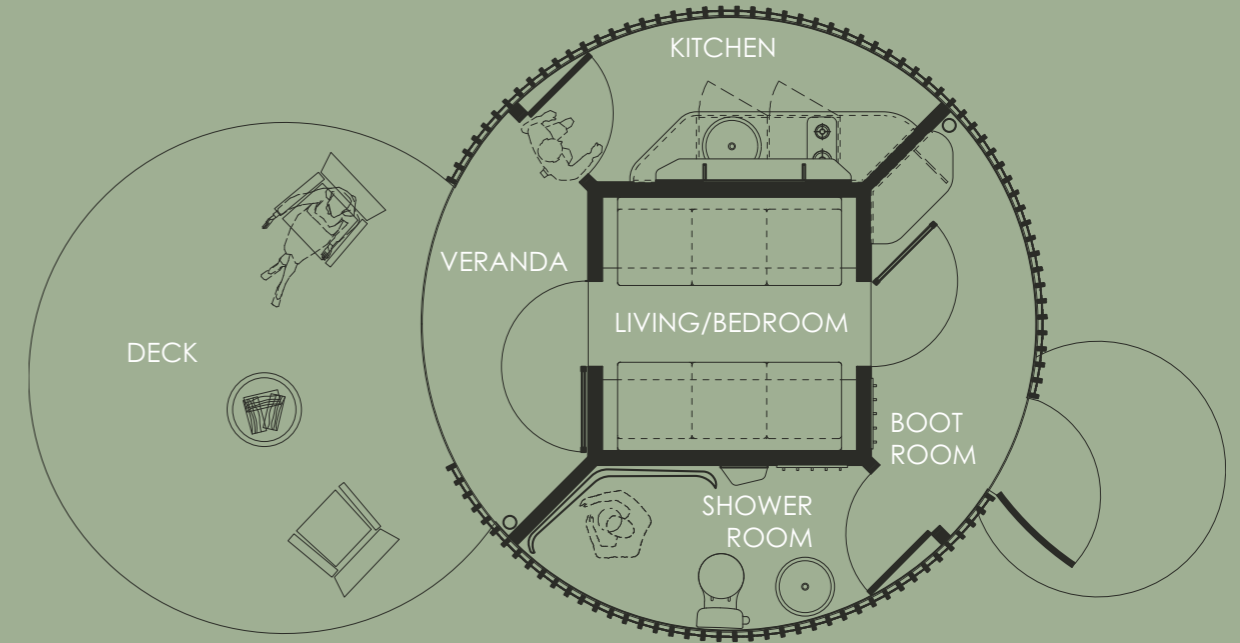

	STANDARD	OPTIONAL EXTRAS
LIVING/BEDROOM	4.7m ² insulated core Fitted furniture High performance windows and doors	
KITCHEN	Fitted kitchen including sink & hob High level shelving Timber access door	Fridge freezer Oven Radiant heating
SHOWER ROOM	Fitted shower room with shower and toilet Timber access door with lock	Radiant heating Compost toilet
BOOT ROOM	Coat hanging	Fitted bench and shoe rack
VERANDA		Sliding doors to enclose veranda

3.6 x 3.6m core

Diameter - 7m

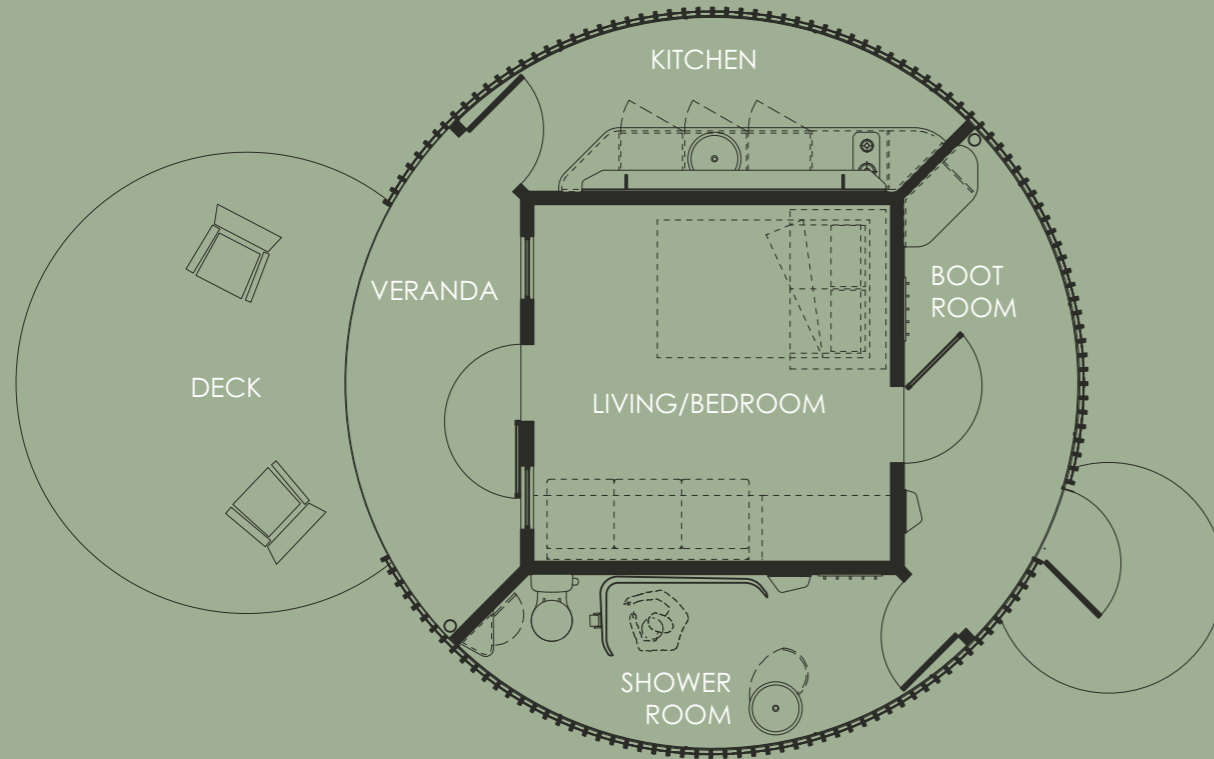

2.4 x 3.6m core

Dimensions = 5.8x6.5m

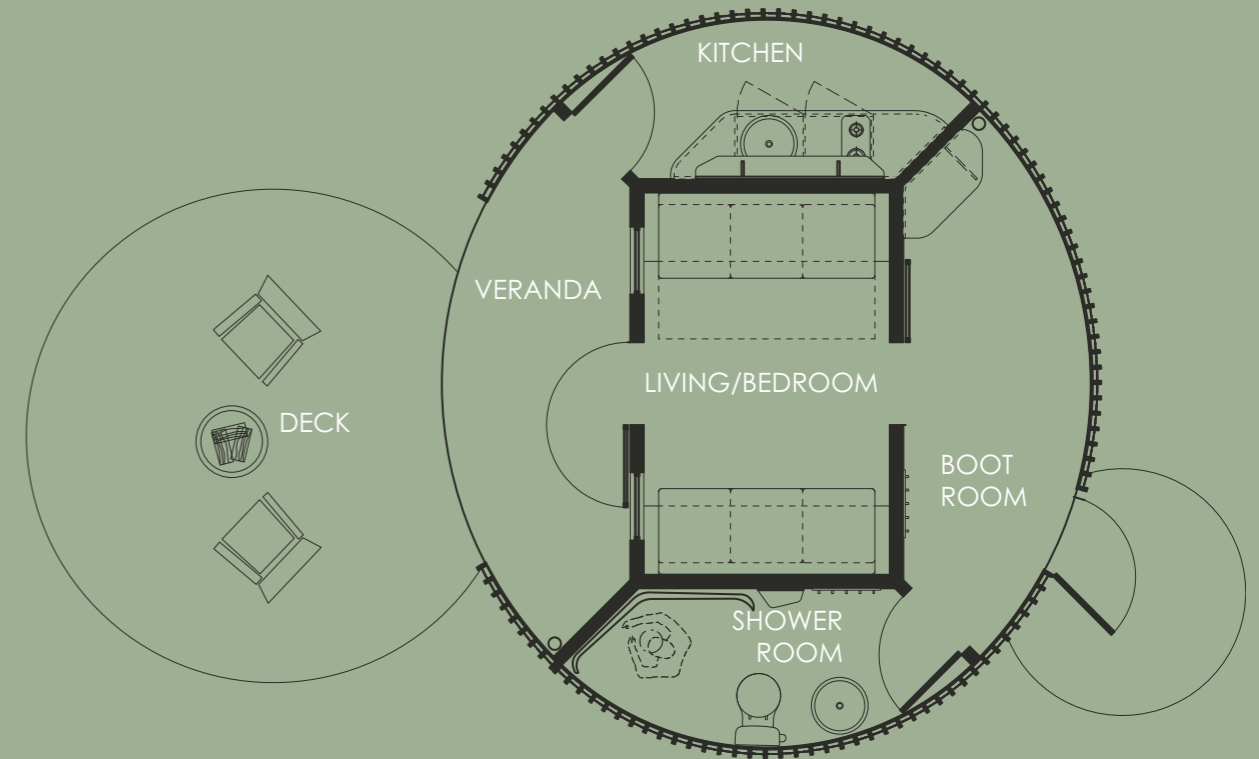

	STANDARD	OPTIONAL EXTRAS
LIVING/BEDROOM	11.3m ² insulated core High performance windows and doors	Furniture
KITCHEN	Fitted kitchen including sink & hob High level shelving Timber access door	Fridge freezer Oven Radiant heating
SHOWER ROOM	Fitted shower room with shower Free standing basin and toilet Timber access door with lock	Radiant heating Compost toilet
BOOT ROOM	Coat hanging	Fitted bench and shoe rack
VERANDA		Sliding doors to enclose veranda

	STANDARD	OPTIONAL EXTRAS
LIVING/BEDROOM	7.3m ² insulated core Fitted furniture with double sofa bed High performance windows and doors	
KITCHEN	Fitted kitchen including sink & hob High level shelving Timber access door	Fridge freezer Oven Radiant heating
SHOWER ROOM	Fitted shower room with shower Free standing basin and toilet Timber access door with lock	Radiant heating Compost toilet
BOOT ROOM	Coat hanging	Fitted bench and shoe rack
VERANDA		Sliding doors to enclose veranda

3.6 x 2.4m core

Dimensions = 6.5x5.8m

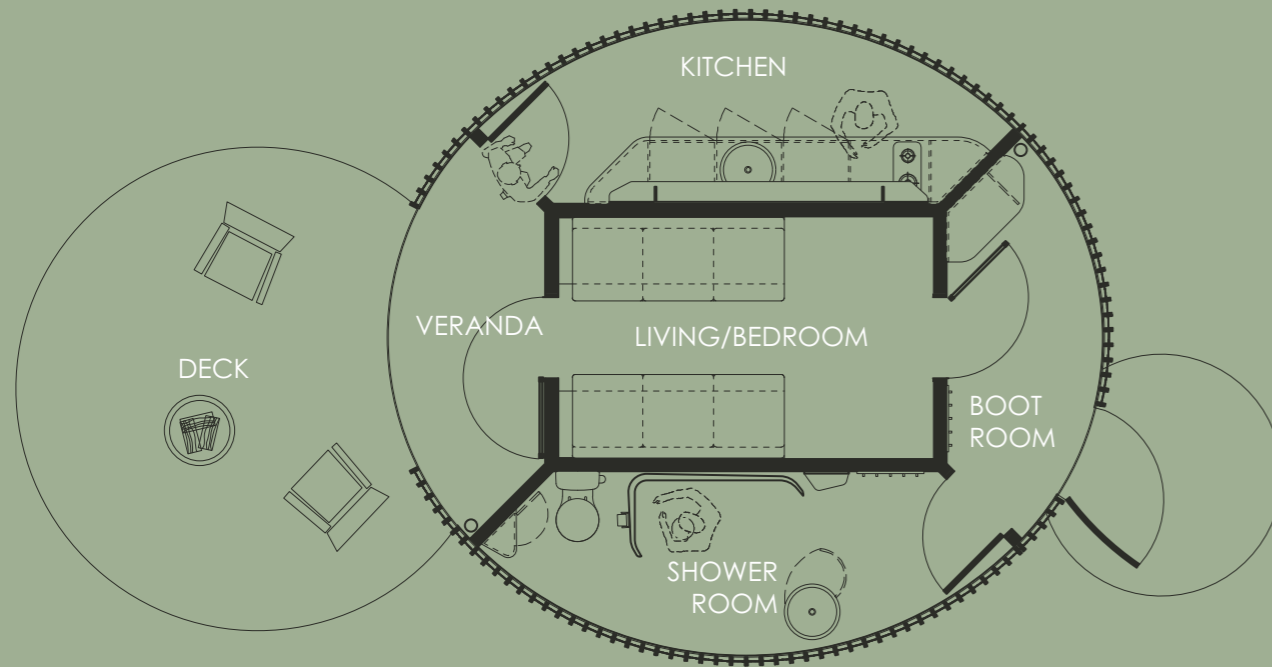

LIVING/BEDROOM

The central insulated core of the Helygen®, which provides the main living and sleeping space, is constructed with structural insulated panels (SIPs). Structures built utilising SIPs typically have excellent insulation standards and lower running costs, compared to structures utilising alternative materials.

Depending on the size and configuration of the model chosen, the core is able to comfortably accommodate between two and four people.

BOOT ROOM

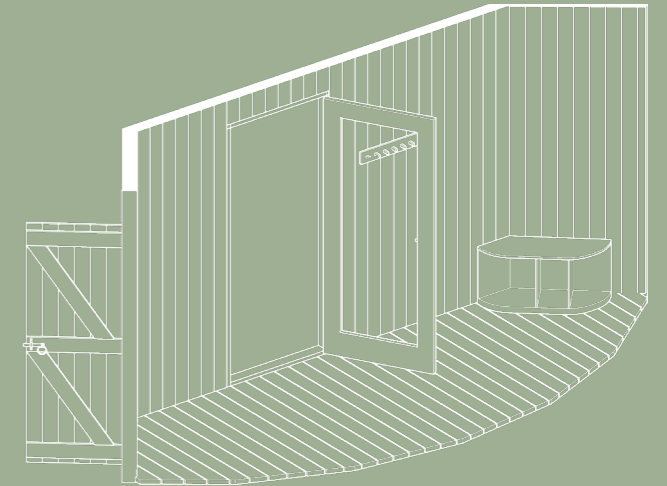

The shower room and living/bedroom are accessed via the boot room. Dirty boots, muddy clothing and wet activity wear can be removed without having to soil the living space. Ample storage exists for spare bedding, suitcases and visiting pets.

VERANDA

On a wet day, views can be enjoyed from the veranda. To increase comfort and versatility of the Helygen®, glazed sliding doors can be commissioned to enclose the veranda from the elements. The veranda can provide access to an open decked area that can be designed to suit the nature of the site. The decking can be used for barbecues and stargazing, with easy access via the veranda to the kitchen. The open-air decking area is for the whole family, with sufficient space to house an array of patio furniture.

	STANDARD	OPTIONAL EXTRAS
LIVING/BEDROOM	7.3m ² insulated core Fitted furniture with two sofa beds High performance windows and doors	
KITCHEN	Fitted kitchen including sink & hob High level shelving Timber access door	Fridge freezer Oven Radiant heating
SHOWER ROOM	Fitted shower room with shower Free standing basin and toilet Timber access door with lock	Radiant heating Compost toilet
BOOT ROOM	Coat hanging	Fitted bench and shoe rack
VERANDA		Sliding doors to enclose veranda

**Illustrations show 3.6 by 3.6m model*



KITCHEN

Natural light floods the kitchen thanks to floor to ceiling windows and a translucent ceiling.

Our kitchen is not housed within the living space. Our hand crafted kitchen has the added benefit of being equipped with a double hob, ample storage and space for a fridge-freezer and oven. Radiant heating can be installed to effectively heat the space whilst in use.

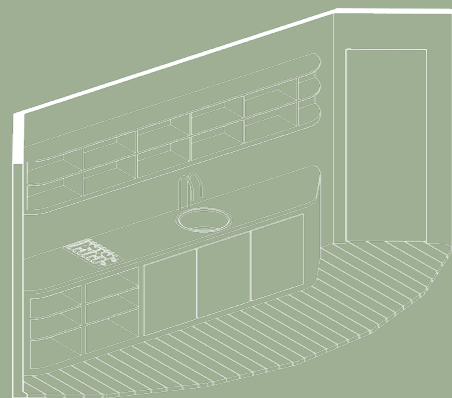

**Illustrations show 3.6 by 3.6m model*

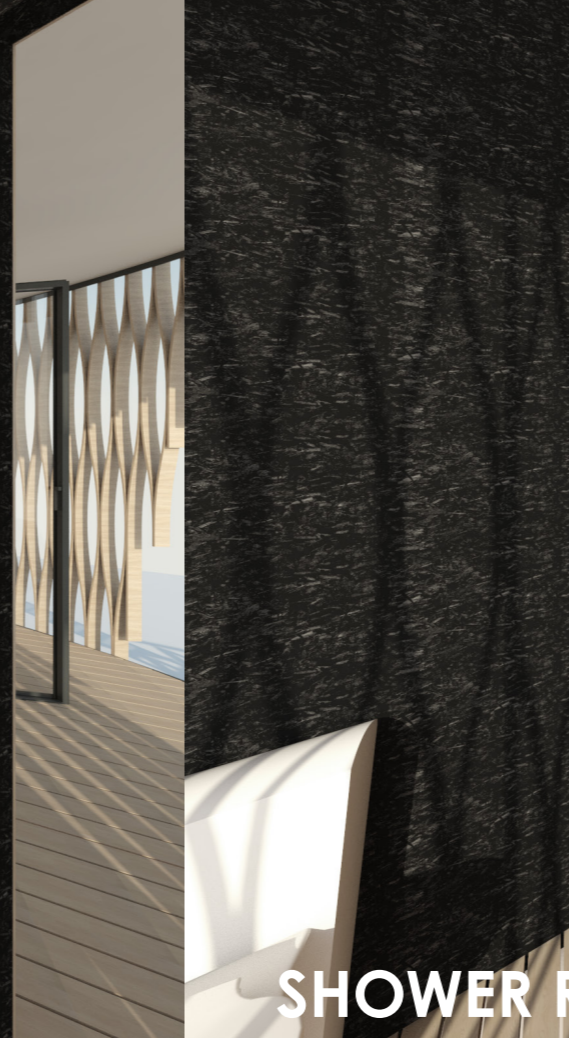

SHOWER ROOM

The shower room also benefits from floor to ceiling windows and a translucent ceiling. The space can be effectively heated by the addition of a radiant heat source.

A wet room shower drains through a deck that seamlessly blends with the rest of the room.

The pedestal basin is located to allow optimum use of natural light.

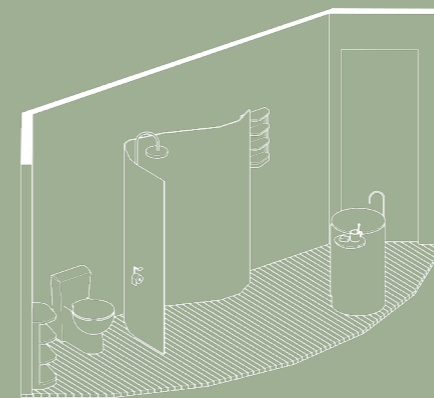

**Illustrations show 3.6 by 3.6m model*

MATERIALS + FITTINGS

Structurally Insulated Panels (SIPS):

The SIPS panels are used to create a core which is highly insulated, providing a comfortable thermal environment in all weather. Manufactured locally to our studio, we ensure minimal transport emissions and work closely with the manufacturer to provide quality assurance.

Welsh Larch:

All of our larch cladding boards are from the local area and cut to size at a local saw mill. As untreated timber, the larch becomes a silvery grey over time.



Marmoleum Floor:

Marmoleum has a very low carbon footprint. It is composed of 97% natural materials and uses 43% recycled materials.

Windows & Doors:

All the windows and doors are made up of glass, wood and aluminium. The wood is FSC certified. The windows and doors have a lifespan of at least 40 years, with a 12-year product warranty from the manufacturer.

Heating:

The Helygen® requires minimal heating due to its highly insulated core, but radiant heating panels and electric bathroom radiators are included as standard in all models.



EPDM Roof Finish:

EPDM has a low GWP (global warming potential) and can be reused and recycled into many different products. It has a life span of between 25-50 years and doesn't pollute rainwater so is an ideal material for rainwater harvesting. This finish can be used in conjunction with a sedum roof.

Wood finishes:

We source all of our internal wood finishes from FSC certified manufacturers and renewable sources of timber. Wood used as internal cladding and flooring offers excellent strength and durability.



Internal fittings:

The attention to detail is evident in the choice of fittings and finishes which complement the qualities of the natural materials used.

Whenever possible we specify LED and energy saving light fixtures to make sure lighting systems are efficient and long lasting.

The interior design of each cabin can be customised to suit individual preferences and a choice of materials, colours and textures are available



OPTIONAL EXTRAS

The Helygen® standard model can be easily customised with optional extras, practical additions and bespoke furniture.

Furniture

We work with local craftsmen who can design and build integrated shelving, consoles, desks or any piece of furniture that may be required.



The access area can be complemented with a deck and pergola.

Deck

The external deck is made of composite decking boards, which are stain and slip-resistant. Composite decking boards are low maintenance and are a strong, sustainable alternative to timber.

Pergola

The pergola frames the structure and provides solar shading, protecting the interior from excessive glare on very sunny days.



QUALITY & CRAFTSMANSHIP

Trust, reputation and reliability are the hallmarks of our chosen local craftspeople. We made the decision to manufacture our pods in a dedicated facility in the heart of Wales, a stone's throw away from our design studio. We are able to undertake regular site visits to ensure our delivery team on the ground have the support they need to exceed expectations.

Our use of quality components including internal cladding, high-quality windows and doors, Welsh larch cladding and the highly insulated core work together to deliver a durable, high-performance, and economical space.

The Helygen® has been ergonomically designed with the process of delivery and assembly in mind. Our team will work with you to help ensure that site-specific obstacles that could impact construction, delivery and assembly are carefully logged and assessed. Our processes have been streamlined to deliver ease, peace of mind and long-lasting value.

We have developed robust quality monitoring systems to ensure that the construction of our units meets the high standards we have imposed on ourselves. These standards have been influenced by our professional training and experience, together with feedback from end users. We monitor our processes at regular intervals to ensure we learn from each stage of each and every build. Upon delivery, our team will undertake final checks to ensure the Helygen® is assembled to agreed parameters.





19 new road
llandeilo
carmarthenshire
sa19 6dd

01558 822009

info@mwd.wales

mwd.wales